

ITEM NO.	PART NUMBER	DESCRIPTION	QTY.
1	Particle Board 4' x 4' x 5/8" thick	Comes in 8' lengths	4
2	FRP 4' x 4'	White, sold in 8' lengths Lowes Item # 8566	4
3	FRP Divider 48" long	White, sold in 8' lengths Lowes Item # 8567 (see note 1)	4
4	43.0 inch pvc	1" ID SCH 40 - buy 6 10' sections	2
5	36.0 inch pvc	1" ID SCH 40 - buy 6 10' sections	2
6	34.5 inch pvc	1" ID SCH 40 - buy 6 10' sections	2
7	21.0 inch pvc	1" ID SCH 40 - buy 6 10' sections	4
8	19.5 inch pvc	1" ID SCH 40 - buy 6 10' sections	2
9	16.0 inch pvc	1" ID SCH 40 - buy 6 10' sections	2
10	13.0 inch pvc	1" ID SCH 40 - buy 6 10' sections	2
11	11.0 inch pvc	1" ID SCH 40 - buy 6 10' sections	6
12	09.5 inch pvc	1" ID SCH 40 - buy 6 10' sections	4
13	09.0 inch pvc	1" ID SCH 40 - buy 6 10' sections	8
14	07.5 inch pvc	1" ID SCH 40 - buy 6 10' sections	2
15	06.0 inch pvc	1" ID SCH 40 - buy 6 10' sections	11
16	01.5 inch pvc	1" ID SCH 40 - buy 6 10' sections	8
17	PVC T Connector	1" SCH 40	26
18	PVC Elbow Connector	1" SCH 40	12
19	PVC End Cap	1" SCH 40	4
20	PVC 1.5in to 1in reducer	SCH 40	2
21	PVC 3in to 1.5in reducer	SCH 40 - Official board uses reducer with hexagonal bottom	2
22	PVC 4in to 3in reducer	SCH 40 (see note 2)	2
23	PVC 4in coupler	SCH 40 (see note 2)	4
24	Floursecent Tube Guard	4' Tube Guard T12 Lowes Item # 163817	1
25	Shelf board 12in x 24in x 5/8" thick	Actual size smaller, white plastic coated	1
26	Half round 5/8" wide 38in long	In the trim section (listed as 1/2") and sold by the foot	1

1. All FRP divider has the same part number, but it comes in different sizes. Choose the widest (1.44" wide at the widest part)

2. In some regions, these parts are only made in black ABS plastic. The official boards will use white PVC. If you would like to simulate the board, paint the black ABS semi-gloss white.

UNLESS OTHERWISE SPECIFIED:		NAME	DATE	TITLE:  <h1>Shopping List</h1>	
DIMENSIONS ARE IN INCHES		DRAWN			
TOLERANCES:		CHECKED			
FRACTIONAL ±		ENG APPR.			
ANGULAR: MACH ±    BEND ±		MFG APPR.			
TWO PLACE DECIMAL ±		Q.A.		SIZE    DWG. NO.    REV <b>A</b> 2011 BB	
THREE PLACE DECIMAL ±		COMMENTS:			
INTERPRET GEOMETRIC TOLERANCING PER:					
MATERIAL					
FINISH				SCALE: 1:50	
DO NOT SCALE DRAWING				WEIGHT:	
				SHEET 1 OF 18	

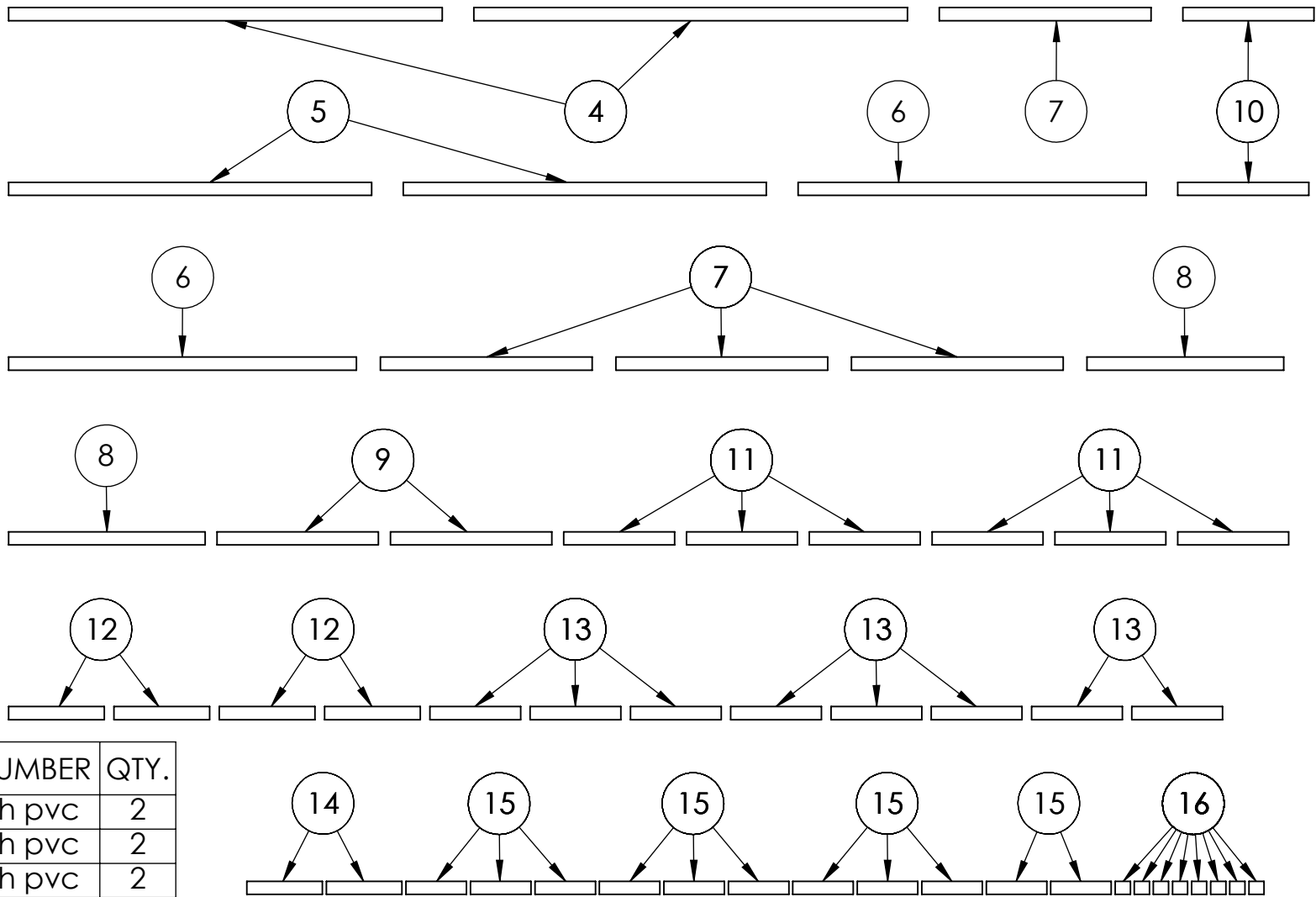

ITEM NO.	PART NUMBER	QTY.
4	43.0 inch pvc	2
5	36.0 inch pvc	2
6	34.5 inch pvc	2
7	21.0 inch pvc	4
8	19.5 inch pvc	2
9	16.0 inch pvc	2
10	13.0 inch pvc	2
11	11.0 inch pvc	6
12	09.5 inch pvc	4
13	09.0 inch pvc	8
14	07.5 inch pvc	2
15	06.0 inch pvc	11
16	01.5 inch pvc	8

#### Comments:

Each row can be cut from 1 standard 10 ft. length of PVC

Unless otherwise specified, all PVC is 1" ID schedule 40

	NAME	DATE	TITLE:		
DRAWN			PVC Cuts		
CHECKED					
ENG APPR.			SIZE	DWG. NO.	REV
MFG APPR.			<b>A</b>	<b>2011 BB</b>	
Q.A.			SCALE: 1:50 WEIGHT:		SHEET 2 OF 18

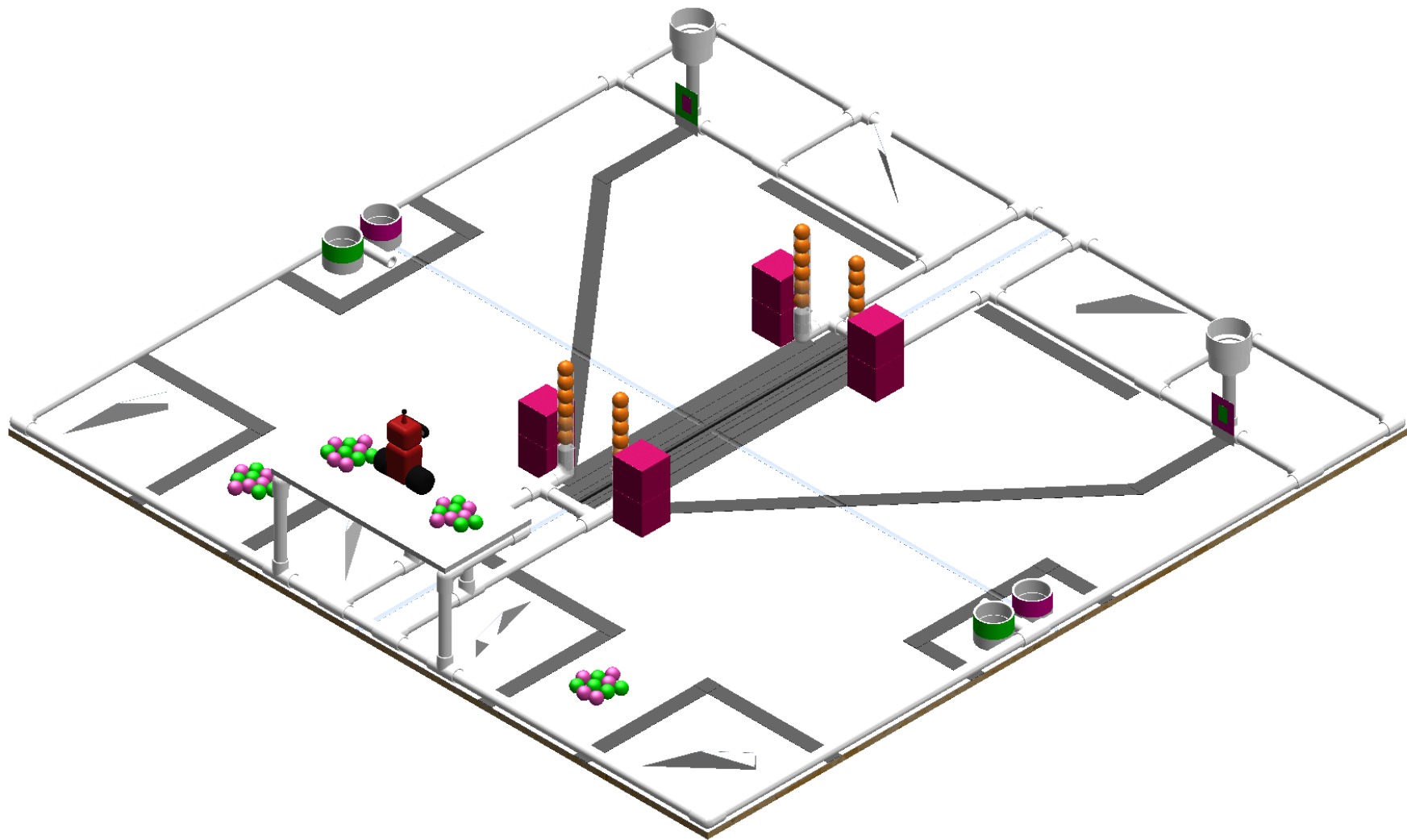

**PROPRIETARY AND CONFIDENTIAL**  
 THE INFORMATION CONTAINED IN THIS  
 DRAWING IS THE SOLE PROPERTY OF  
 <INSERT COMPANY NAME HERE>. ANY  
 REPRODUCTION IN PART OR AS A WHOLE  
 WITHOUT THE WRITTEN PERMISSION OF  
 <INSERT COMPANY NAME HERE> IS  
 PROHIBITED.

		UNLESS OTHERWISE SPECIFIED:	NAME	DATE
		DIMENSIONS ARE IN INCHES	DRAWN	
		TOLERANCES:	CHECKED	
		FRACTIONAL ±	ENG APPR.	
		ANGULAR: MACH ± BEND ±	MFG APPR.	
		TWO PLACE DECIMAL ±	Q.A.	
		THREE PLACE DECIMAL ±	COMMENTS:	
		INTERPRET GEOMETRIC TOLERANCING PER:		
		MATERIAL		
NEXT ASSY	USED ON	FINISH		
APPLICATION		DO NOT SCALE DRAWING		

TITLE:		
Overview		
SIZE	DWG. NO.	REV
A	2011 BB	
SCALE: 1:50		WEIGHT:
		SHEET 3 OF 18

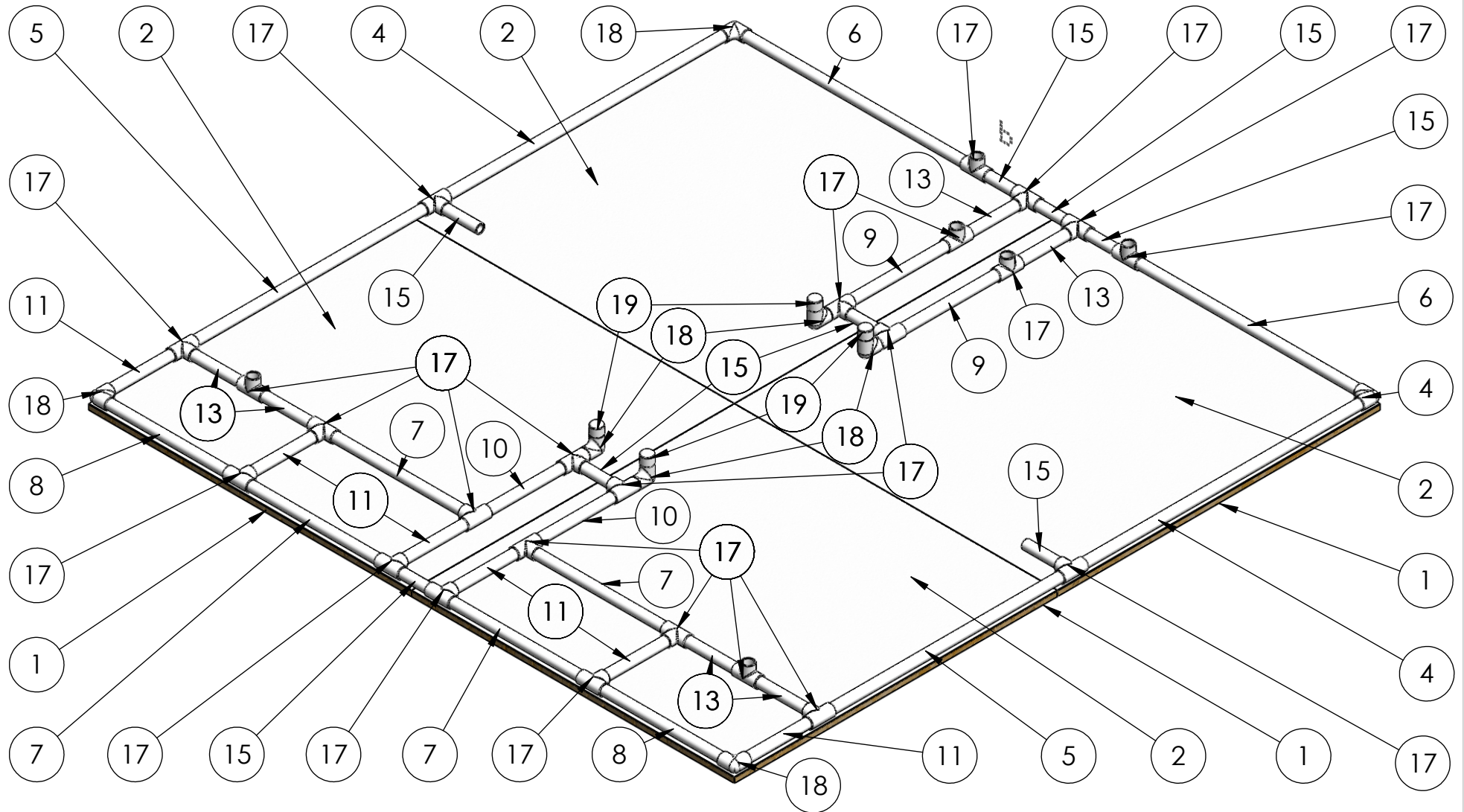

**PROPRIETARY AND CONFIDENTIAL**  
 THE INFORMATION CONTAINED IN THIS  
 DRAWING IS THE SOLE PROPERTY OF  
 <INSERT COMPANY NAME HERE>. ANY  
 REPRODUCTION IN PART OR AS A WHOLE  
 WITHOUT THE WRITTEN PERMISSION OF  
 <INSERT COMPANY NAME HERE> IS  
 PROHIBITED.

		UNLESS OTHERWISE SPECIFIED:		NAME	DATE
		DIMENSIONS ARE IN INCHES		DRAWN	
		TOLERANCES:		CHECKED	
		FRACTIONAL $\pm$		ENG APPR.	
		ANGULAR: MACH $\pm$ BEND $\pm$		MFG APPR.	
		TWO PLACE DECIMAL $\pm$		Q.A.	
		THREE PLACE DECIMAL $\pm$		COMMENTS:	
		INTERPRET GEOMETRIC TOLERANCING PER:			
		MATERIAL			
		FINISH			
NEXT ASSY	USED ON				
APPLICATION		DO NOT SCALE DRAWING			

**TITLE:**

# PVC Layout

SIZE **A** DWG. NO. **2011 BB** REV

SCALE: 1:50

WEIGHT:

SHEET 4 OF 18

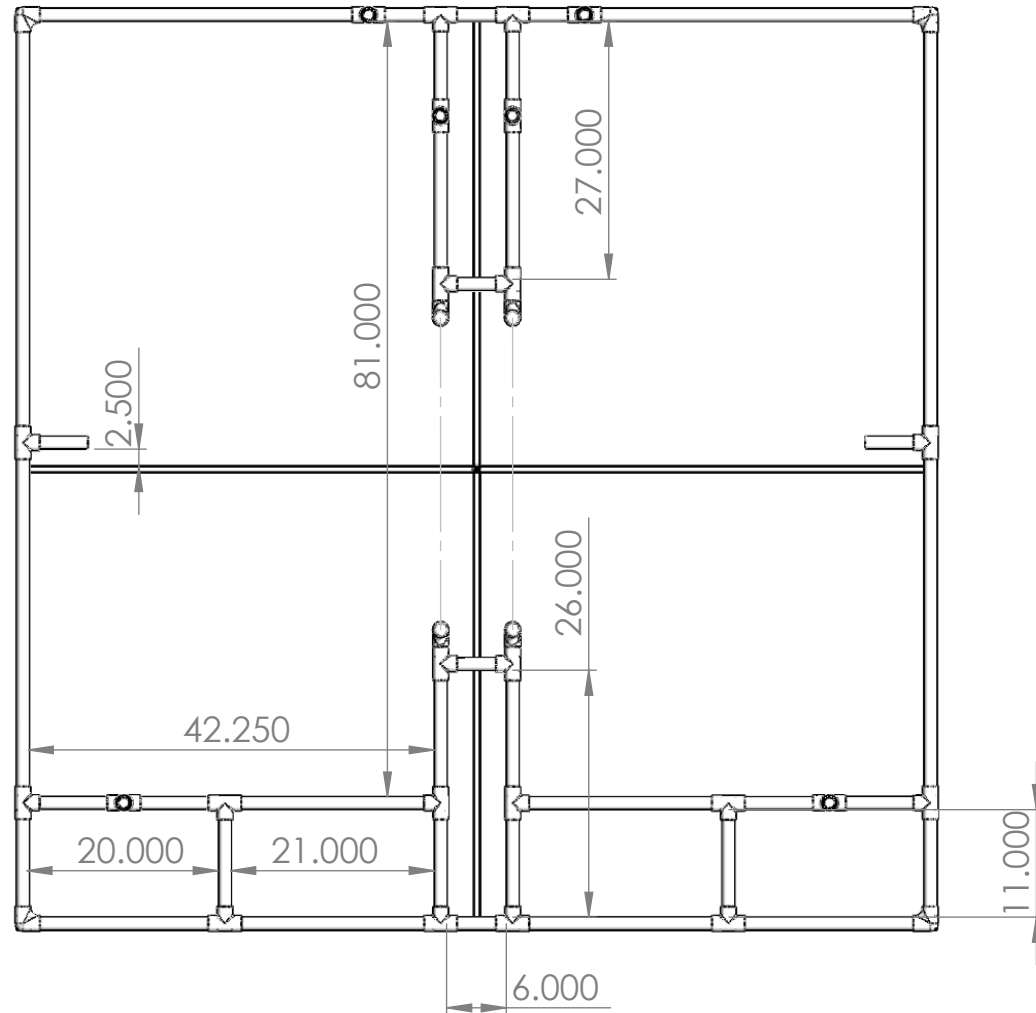

**PROPRIETARY AND CONFIDENTIAL**  
 THE INFORMATION CONTAINED IN THIS  
 DRAWING IS THE SOLE PROPERTY OF  
 <INSERT COMPANY NAME HERE>. ANY  
 REPRODUCTION IN PART OR AS A WHOLE  
 WITHOUT THE WRITTEN PERMISSION OF  
 <INSERT COMPANY NAME HERE> IS  
 PROHIBITED.

		UNLESS OTHERWISE SPECIFIED:		NAME	DATE
		DIMENSIONS ARE IN INCHES	DRAWN		
		TOLERANCES:	CHECKED		
		FRACTIONAL ±	ENG APPR.		
		ANGULAR: MACH ±    BEND ±	MFG APPR.		
		TWO PLACE DECIMAL ±	Q.A.		
		THREE PLACE DECIMAL ±	COMMENTS:		
		INTERPRET GEOMETRIC TOLERANCING PER:			
		MATERIAL			
NEXT ASSY	USED ON	FINISH			
APPLICATION		DO NOT SCALE DRAWING			

TITLE: **Interior PVC  
Measurements**

SIZE DWG. NO. REV  
**A** 2011 Table

SCALE: 1:50 WEIGHT: SHEET 5 OF 18

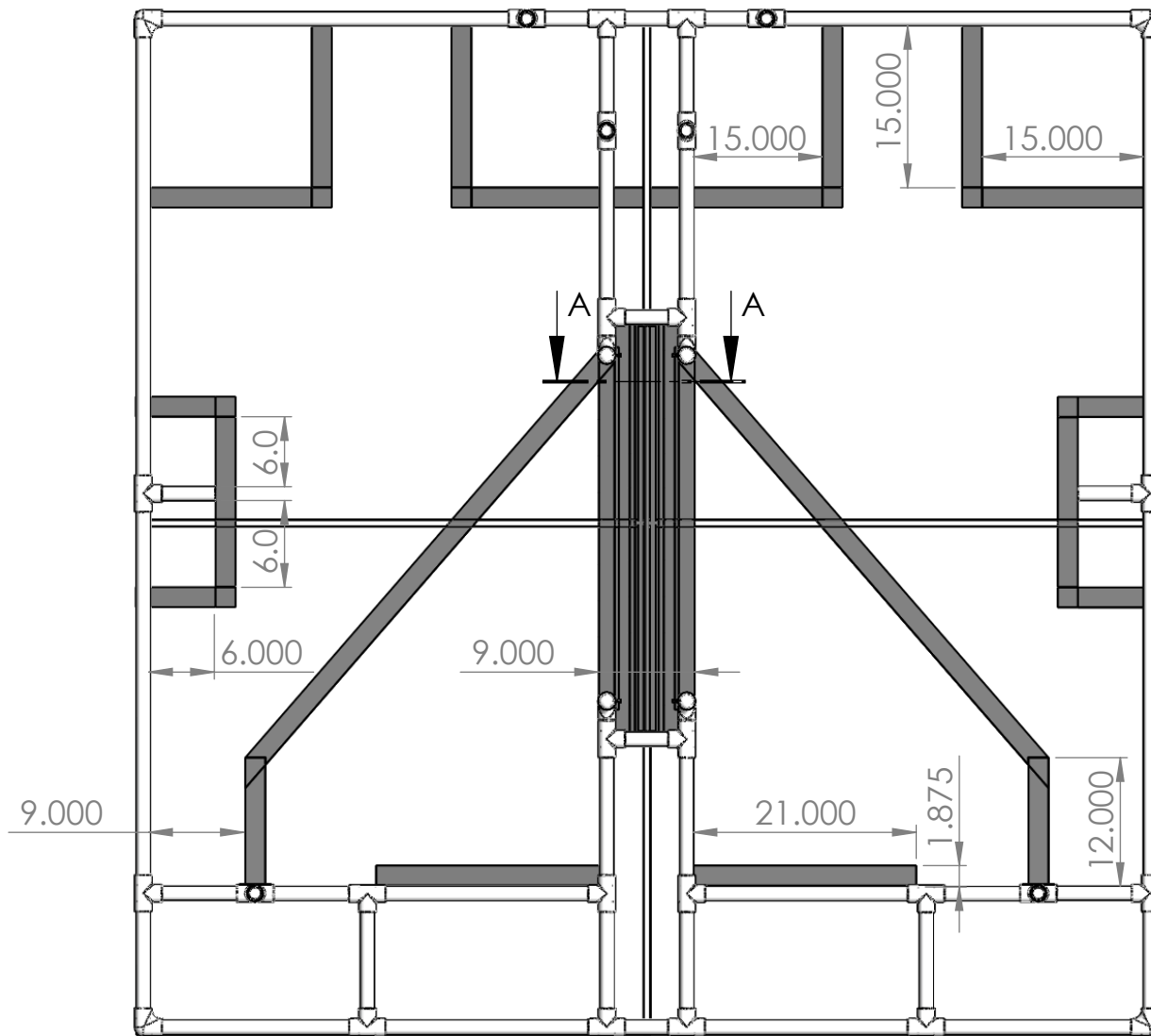

## NOTES:

The center tape is five strips wide and applied directly over the FRP divider. The half round is centered, laid on top of the tape and covered with one additional piece of tape (see cutaway below).

The side boxes are centered on the middle of the 6 inch PVC creating two equal sized boxes.

The long diagonal tape runs from and overlaps the corner of the 12 inch tape to under the ball tube.

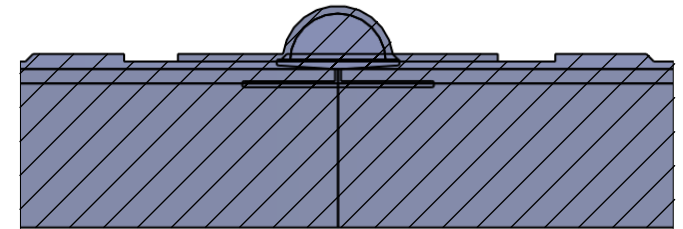

SECTION A-A  
SCALE 1 : 1

**PROPRIETARY AND CONFIDENTIAL**  
THE INFORMATION CONTAINED IN THIS DRAWING IS THE SOLE PROPERTY OF <INSERT COMPANY NAME HERE>. ANY REPRODUCTION IN PART OR AS A WHOLE WITHOUT THE WRITTEN PERMISSION OF <INSERT COMPANY NAME HERE> IS PROHIBITED.

		UNLESS OTHERWISE SPECIFIED:		NAME	DATE	TITLE:  Tape Layout		
		DIMENSIONS ARE IN INCHES	DRAWN					
		TOLERANCES:	CHECKED					
		FRACTIONAL ±	ENG APPR.					
		ANGULAR: MACH±    BEND ±	MFG APPR.					
		TWO PLACE DECIMAL    ±						
		THREE PLACE DECIMAL    ±						
		INTERPRET GEOMETRIC TOLERANCING PER:	Q.A.					
		MATERIAL	COMMENTS:			SIZE	DWG. NO.	REV
		FINISH				<b>A</b>	<b>2011 BB</b>	
NEXT ASSY	USED ON					SCALE: 1:50 WEIGHT:		SHEET 6 OF 18
APPLICATION		DO NOT SCALE DRAWING						

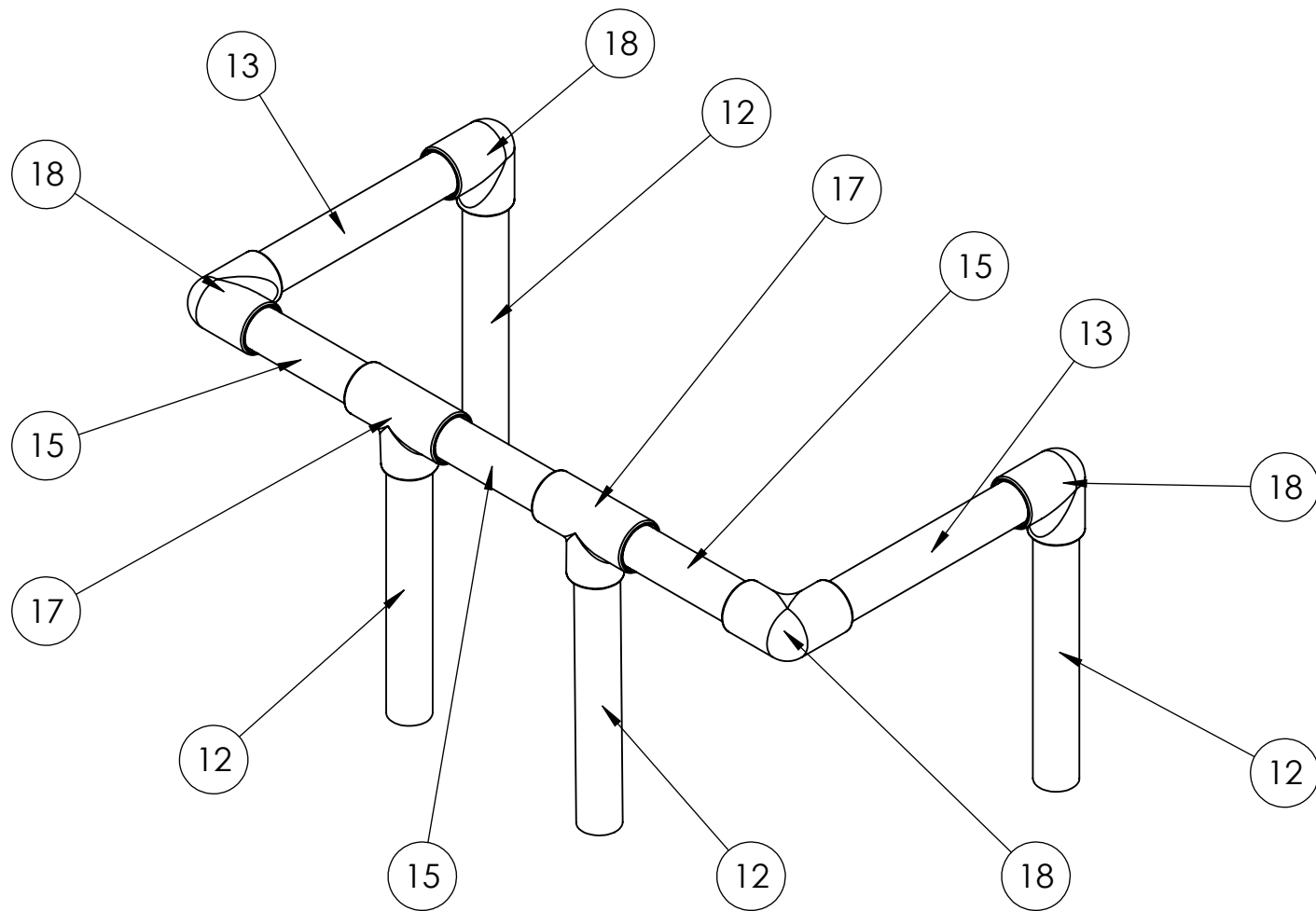

**PROPRIETARY AND CONFIDENTIAL**  
 THE INFORMATION CONTAINED IN THIS  
 DRAWING IS THE SOLE PROPERTY OF  
 <INSERT COMPANY NAME HERE>. ANY  
 REPRODUCTION IN PART OR AS A WHOLE  
 WITHOUT THE WRITTEN PERMISSION OF  
 <INSERT COMPANY NAME HERE> IS  
 PROHIBITED.

		UNLESS OTHERWISE SPECIFIED:		NAME	DATE	TITLE:  <b>Shelf PVC</b>	
		DIMENSIONS ARE IN INCHES	DRAWN				
		TOLERANCES:	CHECKED				
		FRACTIONAL ±	ENG APPR.				
		ANGULAR: MACH ± BEND ±	MFG APPR.				
		TWO PLACE DECIMAL ±	Q.A.			SIZE	DWG. NO.
		THREE PLACE DECIMAL ±	COMMENTS:			<b>A</b>	<b>2011 BB</b>
		INTERPRET GEOMETRIC				REV	
		TOLERANCING PER:					
		MATERIAL					
NEXT ASSY	USED ON	FINISH				SCALE: 1:50 WEIGHT:	
APPLICATION		DO NOT SCALE DRAWING				SHEET 7 OF 18	

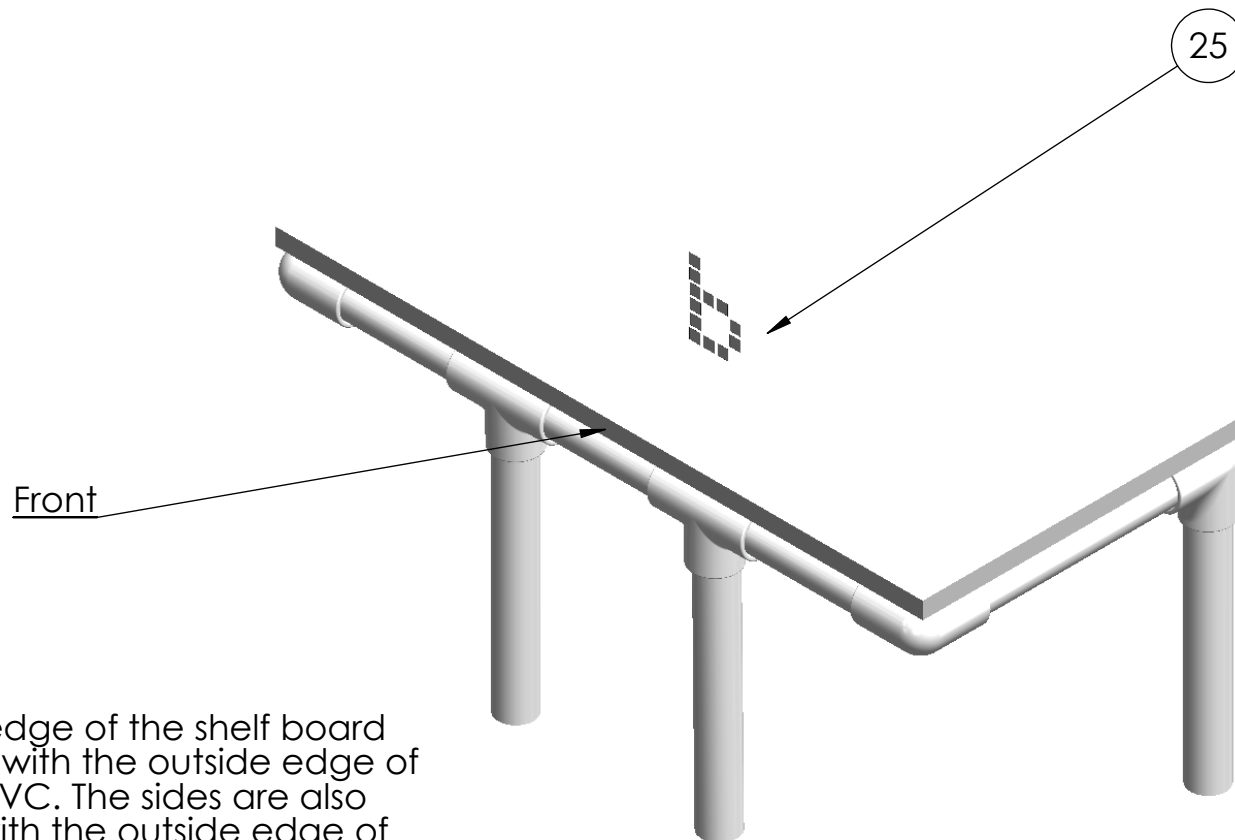

The front edge of the shelf board is lined up with the outside edge of the front PVC. The sides are also lined up with the outside edge of the PVC. If the sides over/under hang the PVC, split the difference between the sides.

Screws are inserted up through holes the elbows in the four corners to secure the shelf board to the PVC

**PROPRIETARY AND CONFIDENTIAL**  
THE INFORMATION CONTAINED IN THIS DRAWING IS THE SOLE PROPERTY OF <INSERT COMPANY NAME HERE>. ANY REPRODUCTION IN PART OR AS A WHOLE WITHOUT THE WRITTEN PERMISSION OF <INSERT COMPANY NAME HERE> IS PROHIBITED.

		UNLESS OTHERWISE SPECIFIED:		NAME	DATE	TITLE:  Shelf Assembly			
		DIMENSIONS ARE IN INCHES	DRAWN						
		TOLERANCES:	CHECKED						
		FRACTIONAL ±	ENG APPR.						
		ANGULAR: MACH ±    BEND ±	MFG APPR.						
		TWO PLACE DECIMAL ±	Q.A.			SIZE    DWG. NO.    REV  A    2011 BB			
		THREE PLACE DECIMAL ±	COMMENTS:						
		INTERPRET GEOMETRIC TOLERANCING PER:							
		MATERIAL							
NEXT ASSY	USED ON	FINISH							
APPLICATION		DO NOT SCALE DRAWING				SCALE: 1:50		WEIGHT:	SHEET 8 OF 18



The height from the top of the game surface to the bottom of the shelf board is 12.5"

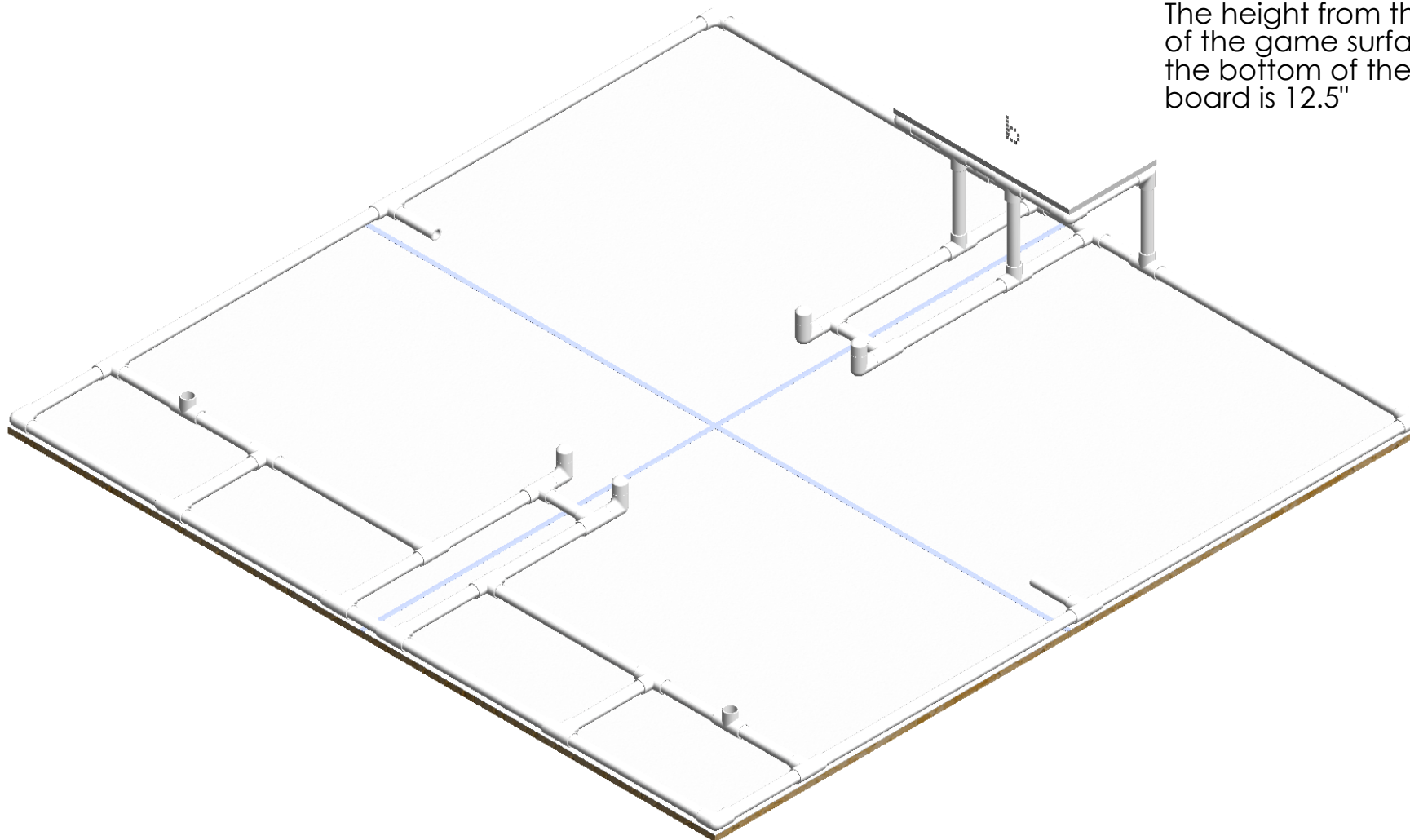

**PROPRIETARY AND CONFIDENTIAL**  
THE INFORMATION CONTAINED IN THIS DRAWING IS THE SOLE PROPERTY OF <INSERT COMPANY NAME HERE>. ANY REPRODUCTION IN PART OR AS A WHOLE WITHOUT THE WRITTEN PERMISSION OF <INSERT COMPANY NAME HERE> IS PROHIBITED.

		UNLESS OTHERWISE SPECIFIED:		NAME	DATE	TITLE:  <b>Installing Shelf</b>	
		DIMENSIONS ARE IN INCHES		DRAWN			
		TOLERANCES:		CHECKED			
		FRACTIONAL ±		ENG APPR.			
		ANGULAR: MACH ± BEND ±		MFG APPR.			
		TWO PLACE DECIMAL ±		Q.A.		SIZE DWG. NO. REV	
		THREE PLACE DECIMAL ±		COMMENTS:			
		INTERPRET GEOMETRIC TOLERANCING PER:					
		MATERIAL				<b>A 2011 BB</b>	
		FINISH					
NEXT ASSY	USED ON					SCALE: 1:50 WEIGHT: SHEET 9 OF 18	
APPLICATION		DO NOT SCALE DRAWING					

5

4

3

2

1

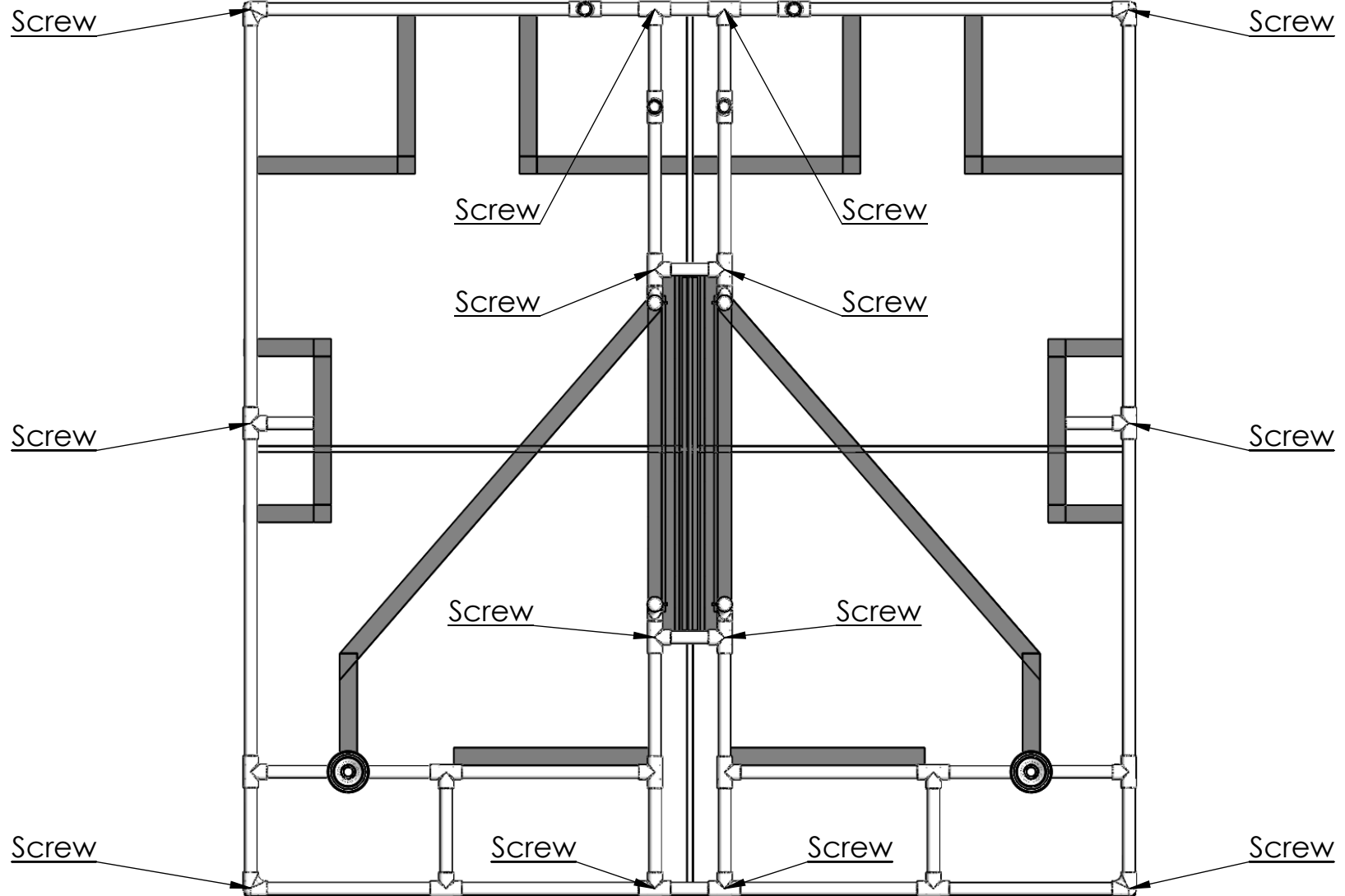

**PROPRIETARY AND CONFIDENTIAL**  
THE INFORMATION CONTAINED IN THIS DRAWING IS THE SOLE PROPERTY OF <INSERT COMPANY NAME HERE>. ANY REPRODUCTION IN PART OR AS A WHOLE WITHOUT THE WRITTEN PERMISSION OF <INSERT COMPANY NAME HERE> IS PROHIBITED.

		UNLESS OTHERWISE SPECIFIED:		NAME	DATE
		DIMENSIONS ARE IN INCHES		DRAWN	
		TOLERANCES:		CHECKED	
		FRACTIONAL $\pm$		ENG APPR.	
		ANGULAR: MACH $\pm$ BEND $\pm$		MFG APPR.	
		TWO PLACE DECIMAL $\pm$		Q.A.	
		THREE PLACE DECIMAL $\pm$		COMMENTS:	
		INTERPRET GEOMETRIC TOLERANCING PER:			
		MATERIAL			
		FINISH			
NEXT ASSY	USED ON				
APPLICATION		DO NOT SCALE DRAWING			

TITLE:		
Screw Locations		
SIZE	DWG. NO.	REV
A	2011 BB	
SCALE: 1:50		WEIGHT:
		SHEET 10 OF 18

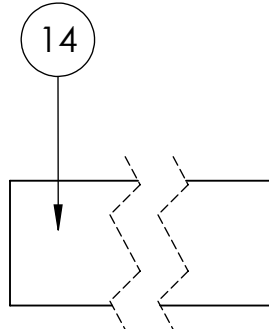
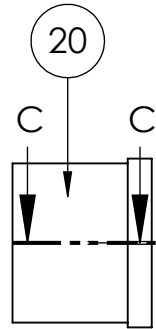
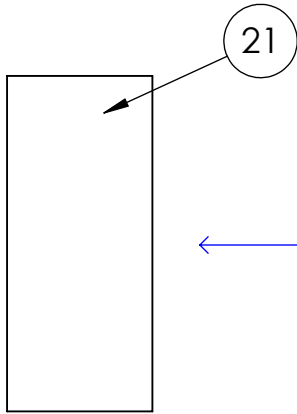
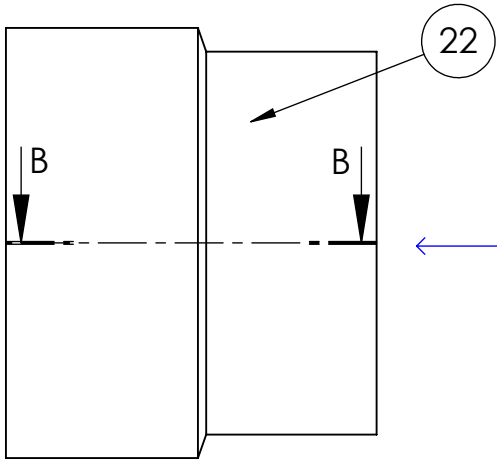

Assemble the parts as tightly as possible

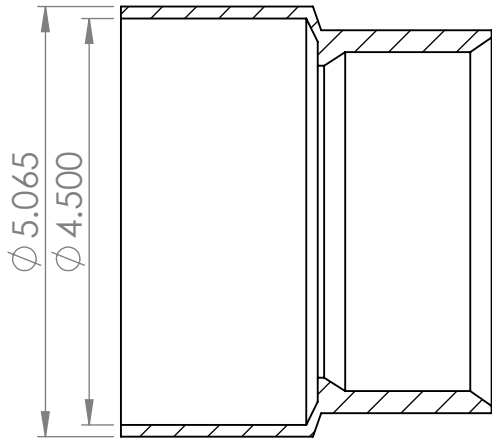

A 1.5" diameter circle of 0.125" thick cardboard is inserted here to facilitate ping pong ball removal

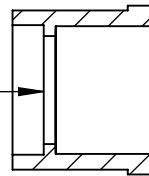

SECTION C-C  
SCALE 1 : 2

**Make 2**

SECTION B-B  
SCALE 1 : 2

**PROPRIETARY AND CONFIDENTIAL**  
THE INFORMATION CONTAINED IN THIS DRAWING IS THE SOLE PROPERTY OF <INSERT COMPANY NAME HERE>. ANY REPRODUCTION IN PART OR AS A WHOLE WITHOUT THE WRITTEN PERMISSION OF <INSERT COMPANY NAME HERE> IS PROHIBITED.

		UNLESS OTHERWISE SPECIFIED:		NAME	DATE	TITLE:  Tower Assembly		
		DIMENSIONS ARE IN INCHES	DRAWN					
		TOLERANCES:	CHECKED					
		FRACTIONAL ±	ENG APPR.					
		ANGULAR: MACH ±    BEND ±	MFG APPR.			SIZE    DWG. NO.    REV <b>A</b> 2011 BB		
		TWO PLACE DECIMAL    ±	Q.A.					
		THREE PLACE DECIMAL    ±	COMMENTS:			SCALE: 1:50    WEIGHT:    SHEET 11 OF 18		
		INTERPRET GEOMETRIC TOLERANCING PER:						
		MATERIAL						
		FINISH						
NEXT ASSY	USED ON							
APPLICATION		DO NOT SCALE DRAWING						

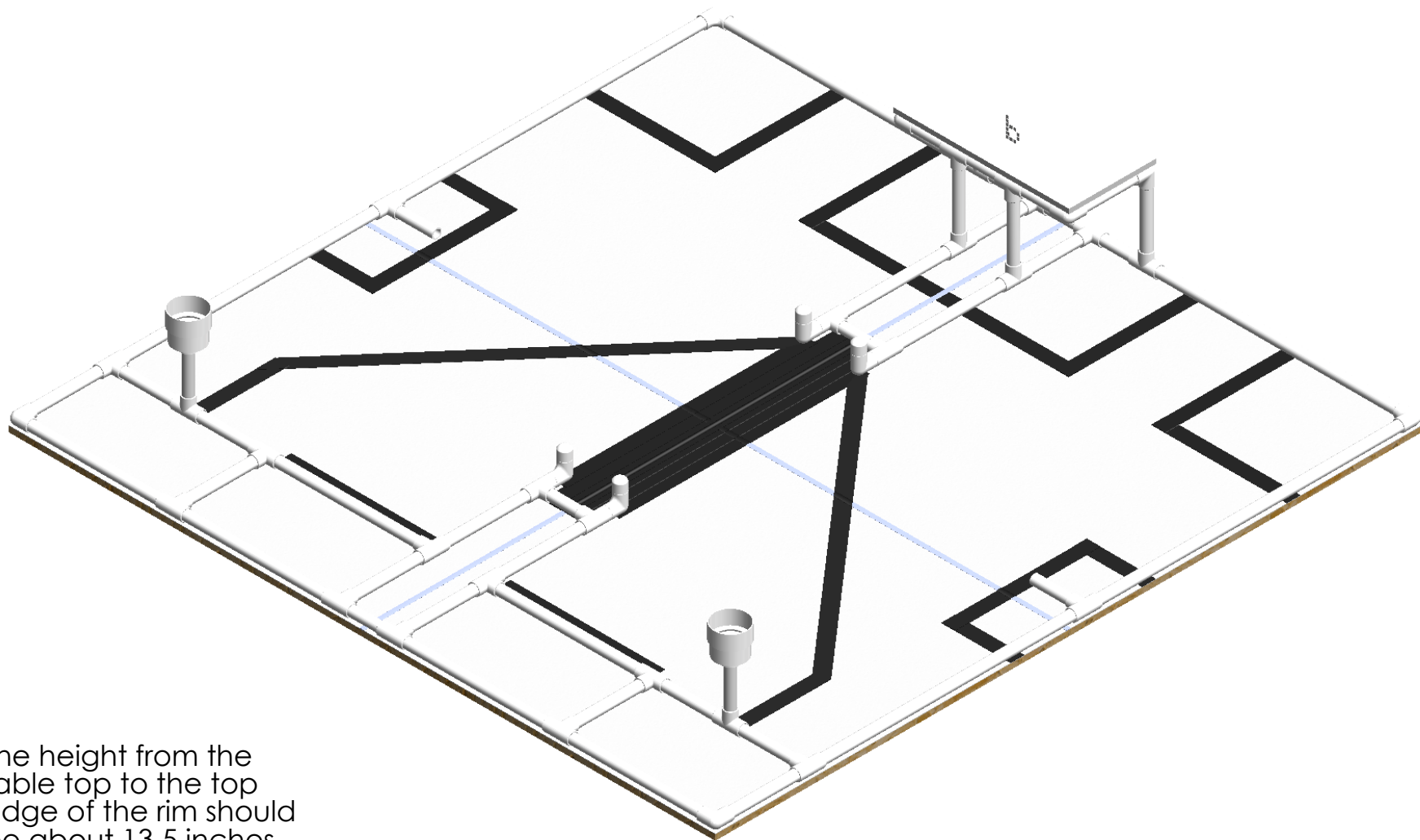

The height from the table top to the top edge of the rim should be about 13.5 inches

**PROPRIETARY AND CONFIDENTIAL**  
THE INFORMATION CONTAINED IN THIS DRAWING IS THE SOLE PROPERTY OF <INSERT COMPANY NAME HERE>. ANY REPRODUCTION IN PART OR AS A WHOLE WITHOUT THE WRITTEN PERMISSION OF <INSERT COMPANY NAME HERE> IS PROHIBITED.

		UNLESS OTHERWISE SPECIFIED:		NAME	DATE		
		DIMENSIONS ARE IN INCHES		DRAWN			
		TOLERANCES:		CHECKED		TITLE:	
		FRACTIONAL ±		ENG APPR.		Installing Towers	
		ANGULAR: MACH ± BEND ±		MFG APPR.			
		TWO PLACE DECIMAL ±		Q.A.			
		THREE PLACE DECIMAL ±		COMMENTS:			
		INTERPRET GEOMETRIC TOLERANCING PER:					
		MATERIAL					
		FINISH					
NEXT ASSY	USED ON						
APPLICATION		DO NOT SCALE DRAWING					

SIZE	DWG. NO.	REV
<b>A</b>	<b>2011 BB</b>	
SCALE: 1:50 WEIGHT:		SHEET 12 OF 18

Cut Line

Instructions:

1. Cut out template on dotted line
2. Cut out hatched area
3. Wrap template around bottom of tube. Line up the bottom tube. Make the center line meet in the back
4. Insert push pin to hold template
5. Mark the opening
6. Remove template
7. Cut marked oval out of tube
8. Replace push pin
9. Place a small piece of electrical tape over the pin head

The length from the inside of the pin head to the point should be 0.5 in.

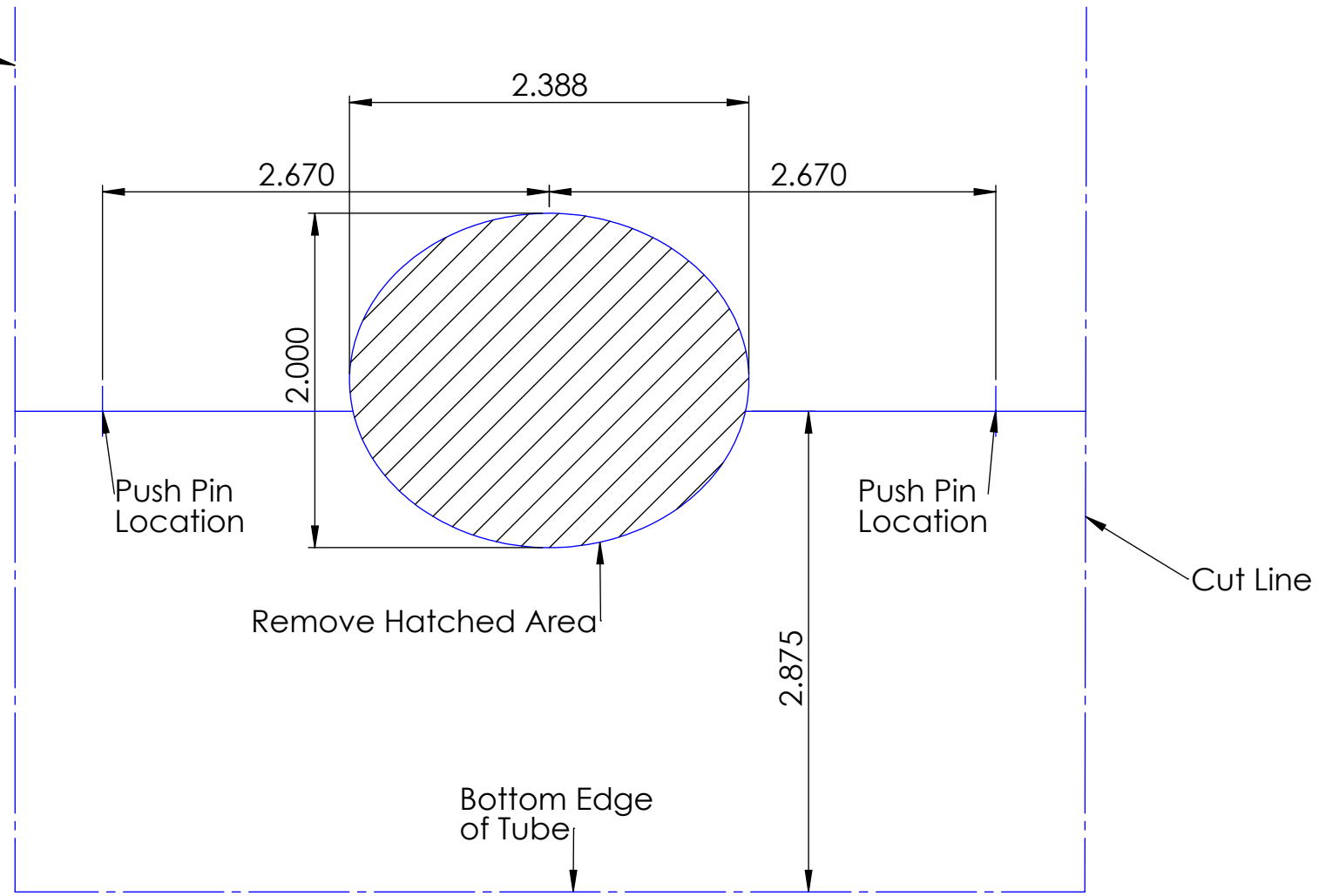

**PROPRIETARY AND CONFIDENTIAL**  
THE INFORMATION CONTAINED IN THIS DRAWING IS THE SOLE PROPERTY OF <INSERT COMPANY NAME HERE>. ANY REPRODUCTION IN PART OR AS A WHOLE WITHOUT THE WRITTEN PERMISSION OF <INSERT COMPANY NAME HERE> IS PROHIBITED.

		UNLESS OTHERWISE SPECIFIED:		NAME	DATE		
		DIMENSIONS ARE IN INCHES	DRAWN			TITLE:  <b>Tube Template</b>	
		TOLERANCES:	CHECKED				
		FRACTIONAL ±	ENG APPR.				
		ANGULAR: MACH ± BEND ±	MFG APPR.				
		TWO PLACE DECIMAL ±	Q.A.			SIZE DWG. NO. REV <b>A 2011 BB</b>	
		THREE PLACE DECIMAL ±	COMMENTS:				
		INTERPRET GEOMETRIC TOLERANCING PER:					SCALE 1:1 WEIGHT: SHEET 13 OF 18
		MATERIAL					
NEXT ASSY	USED ON	FINISH					
APPLICATION		DO NOT SCALE DRAWING					

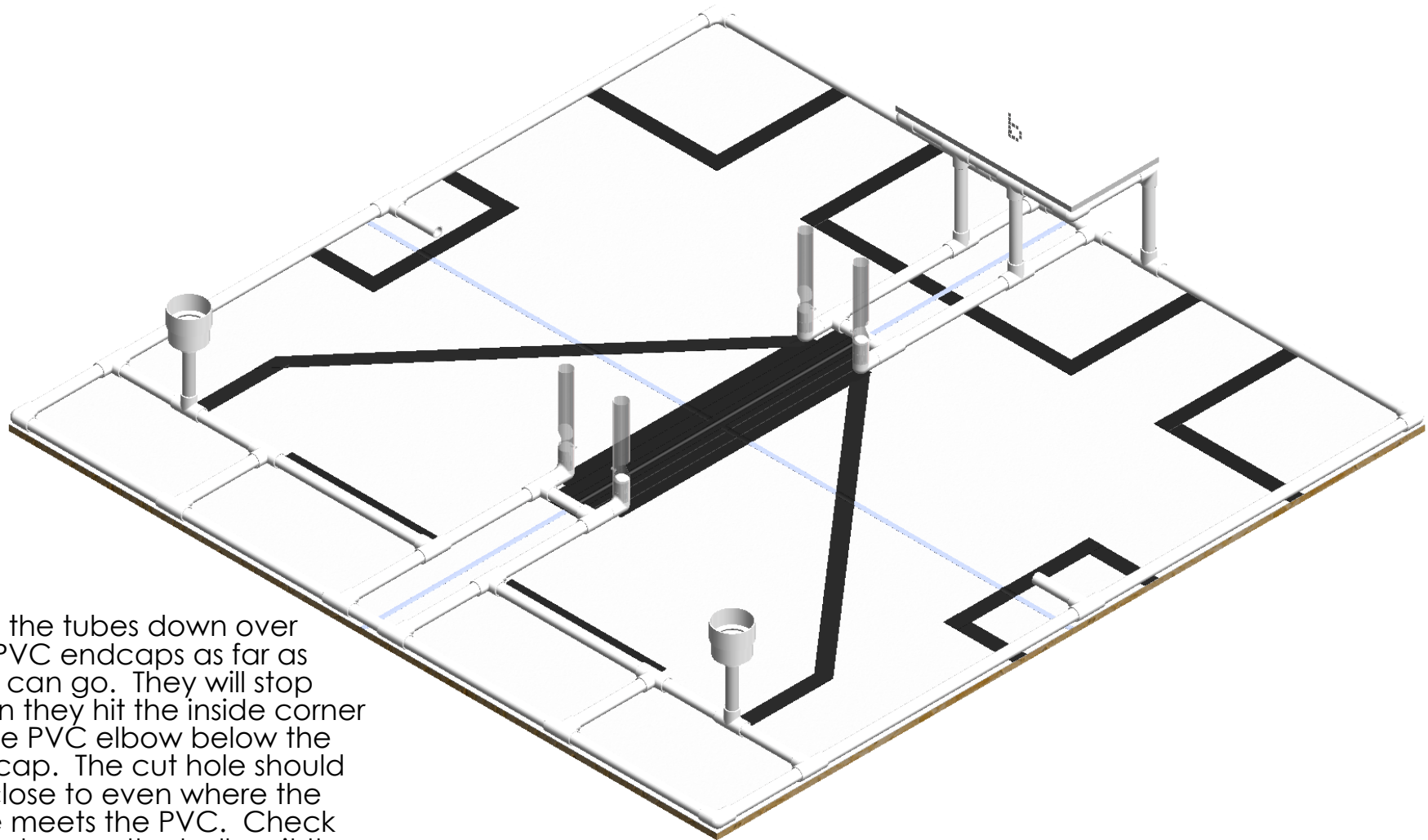

Push the tubes down over the PVC endcaps as far as they can go. They will stop when they hit the inside corner of the PVC elbow below the endcap. The cut hole should be close to even where the tube meets the PVC. Check to make sure the balls exit the tube with out jamming.

**PROPRIETARY AND CONFIDENTIAL**  
THE INFORMATION CONTAINED IN THIS DRAWING IS THE SOLE PROPERTY OF <INSERT COMPANY NAME HERE>. ANY REPRODUCTION IN PART OR AS A WHOLE WITHOUT THE WRITTEN PERMISSION OF <INSERT COMPANY NAME HERE> IS PROHIBITED.

		UNLESS OTHERWISE SPECIFIED:		NAME	DATE		
		DIMENSIONS ARE IN INCHES		DRAWN			
		TOLERANCES:		CHECKED			
		FRACTIONAL ±		ENG APPR.			
		ANGULAR: MACH ± BEND ±		MFG APPR.			
		TWO PLACE DECIMAL ±		Q.A.			
		THREE PLACE DECIMAL ±		COMMENTS:			
		INTERPRET GEOMETRIC TOLERANCING PER:					
		MATERIAL					
		FINISH					
NEXT ASSY		USED ON					
APPLICATION		DO NOT SCALE DRAWING					

TITLE:		
Installing Tubes		
SIZE	DWG. NO.	REV
A	2011 BB	
SCALE: 1:1	WEIGHT:	SHEET 14 OF 18

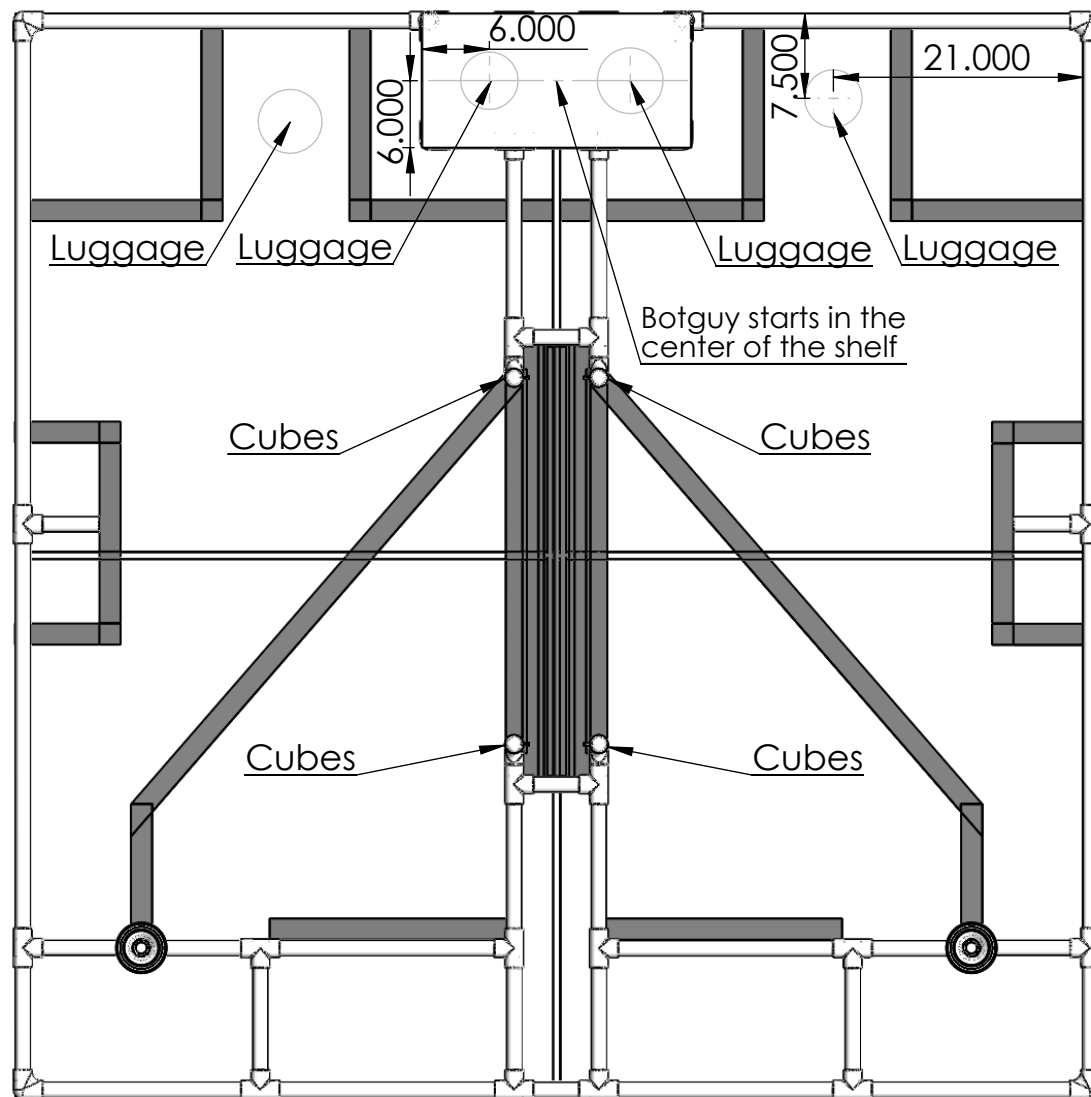

Luggage will be placed randomly inside a 6" diameter circle with the center located as shown. The layout is the same for each side. Cubes start centered in front of the tubes as shown.

**PROPRIETARY AND CONFIDENTIAL**  
THE INFORMATION CONTAINED IN THIS DRAWING IS THE SOLE PROPERTY OF <INSERT COMPANY NAME HERE>. ANY REPRODUCTION IN PART OR AS A WHOLE WITHOUT THE WRITTEN PERMISSION OF <INSERT COMPANY NAME HERE> IS PROHIBITED.

		UNLESS OTHERWISE SPECIFIED:		NAME	DATE	TITLE:  <div>Game Piece Layout</div>		
		DIMENSIONS ARE IN INCHES	DRAWN					
		TOLERANCES:	CHECKED					
		FRACTIONAL ±	ENG APPR.					
		ANGULAR: MACH ±    BEND ±	MFG APPR.					
		TWO PLACE DECIMAL ±	COMMENTS:			SIZE <b>A</b>	DWG. NO. <b>2011 BB</b>	REV
		THREE PLACE DECIMAL ±						
		INTERPRET GEOMETRIC TOLERANCING PER:						
		MATERIAL				SCALE: 1:1    WEIGHT:    SHEET 15 OF 18		
		FINISH						
NEXT ASSY	USED ON							
APPLICATION		DO NOT SCALE DRAWING						

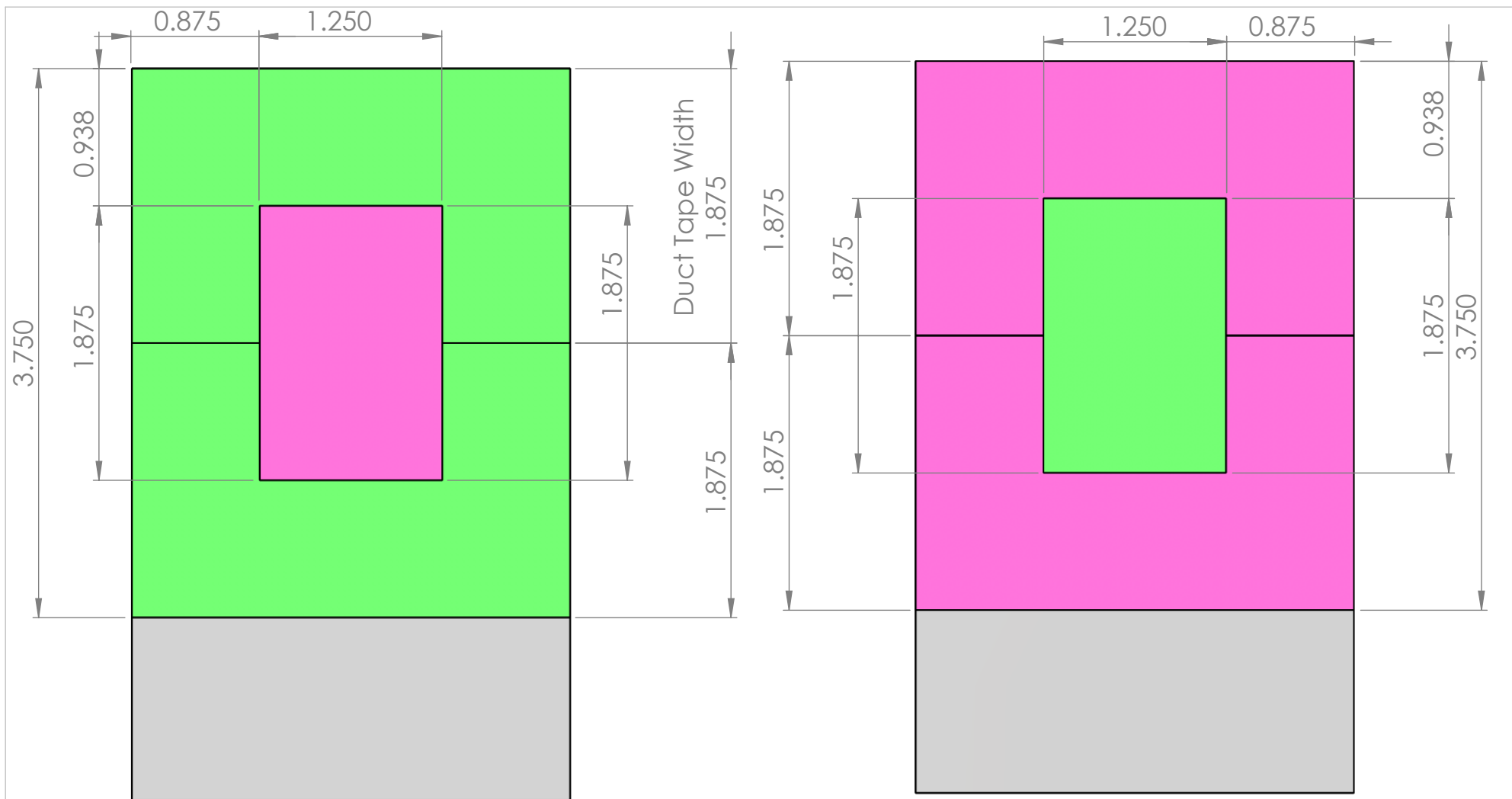

Note:  
Duct tape is applied  
directly to 3" x 5" index  
card.

**PROPRIETARY AND CONFIDENTIAL**  
THE INFORMATION CONTAINED IN THIS  
DRAWING IS THE SOLE PROPERTY OF  
<INSERT COMPANY NAME HERE>. ANY  
REPRODUCTION IN PART OR AS A WHOLE  
WITHOUT THE WRITTEN PERMISSION OF  
<INSERT COMPANY NAME HERE> IS  
PROHIBITED.

		UNLESS OTHERWISE SPECIFIED:		NAME	DATE	TITLE:  <b>Creating Targets</b>
		DIMENSIONS ARE IN INCHES	DRAWN			
		TOLERANCES:	CHECKED			
		FRACTIONAL ±	ENG APPR.			
		ANGULAR: MACH ± BEND ±	MFG APPR.			
		TWO PLACE DECIMAL ±	Q.A.			SIZE DWG. NO. REV <b>A 2011 Table</b>
		THREE PLACE DECIMAL ±	COMMENTS:			
		INTERPRET GEOMETRIC TOLERANCING PER:				SCALE: 1:1
		MATERIAL				WEIGHT:
		FINISH				SHEET 16 OF 18
NEXT ASSY	USED ON	APPLICATION	DO NOT SCALE DRAWING			



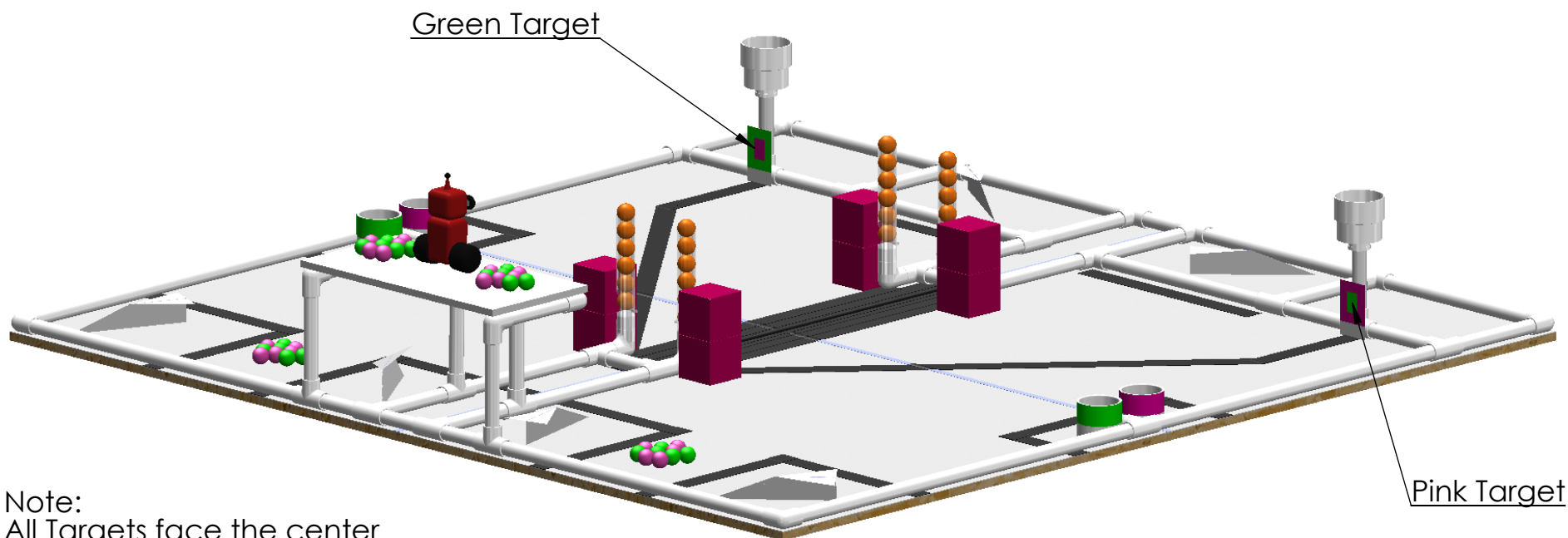

Note:  
 All Targets face the center  
 of the board and are attached  
 with clear or white tape. The  
 targets are white side down.  
 All targets are centered on the PVC.  
 The bottom of the targets touch the table surface.

**PROPRIETARY AND CONFIDENTIAL**  
 THE INFORMATION CONTAINED IN THIS  
 DRAWING IS THE SOLE PROPERTY OF  
 <INSERT COMPANY NAME HERE>. ANY  
 REPRODUCTION IN PART OR AS A WHOLE  
 WITHOUT THE WRITTEN PERMISSION OF  
 <INSERT COMPANY NAME HERE> IS  
 PROHIBITED.

		UNLESS OTHERWISE SPECIFIED:		NAME	DATE		
		DIMENSIONS ARE IN INCHES		DRAWN		TITLE: <b>Target Placement</b>	
		TOLERANCES:		CHECKED			
		FRACTIONAL ±		ENG APPR.			
		ANGULAR: MACH ± BEND ±		MFG APPR.			
		TWO PLACE DECIMAL ±		Q.A.		SIZE DWG. NO. REV	
		THREE PLACE DECIMAL ±		COMMENTS:			
		INTERPRET GEOMETRIC TOLERANCING PER:				<b>A 2011 Table</b>	
		MATERIAL					
		FINISH				SCALE: 1:1 WEIGHT: SHEET 17 OF 18	
NEXT ASSY	USED ON						
APPLICATION		DO NOT SCALE DRAWING					

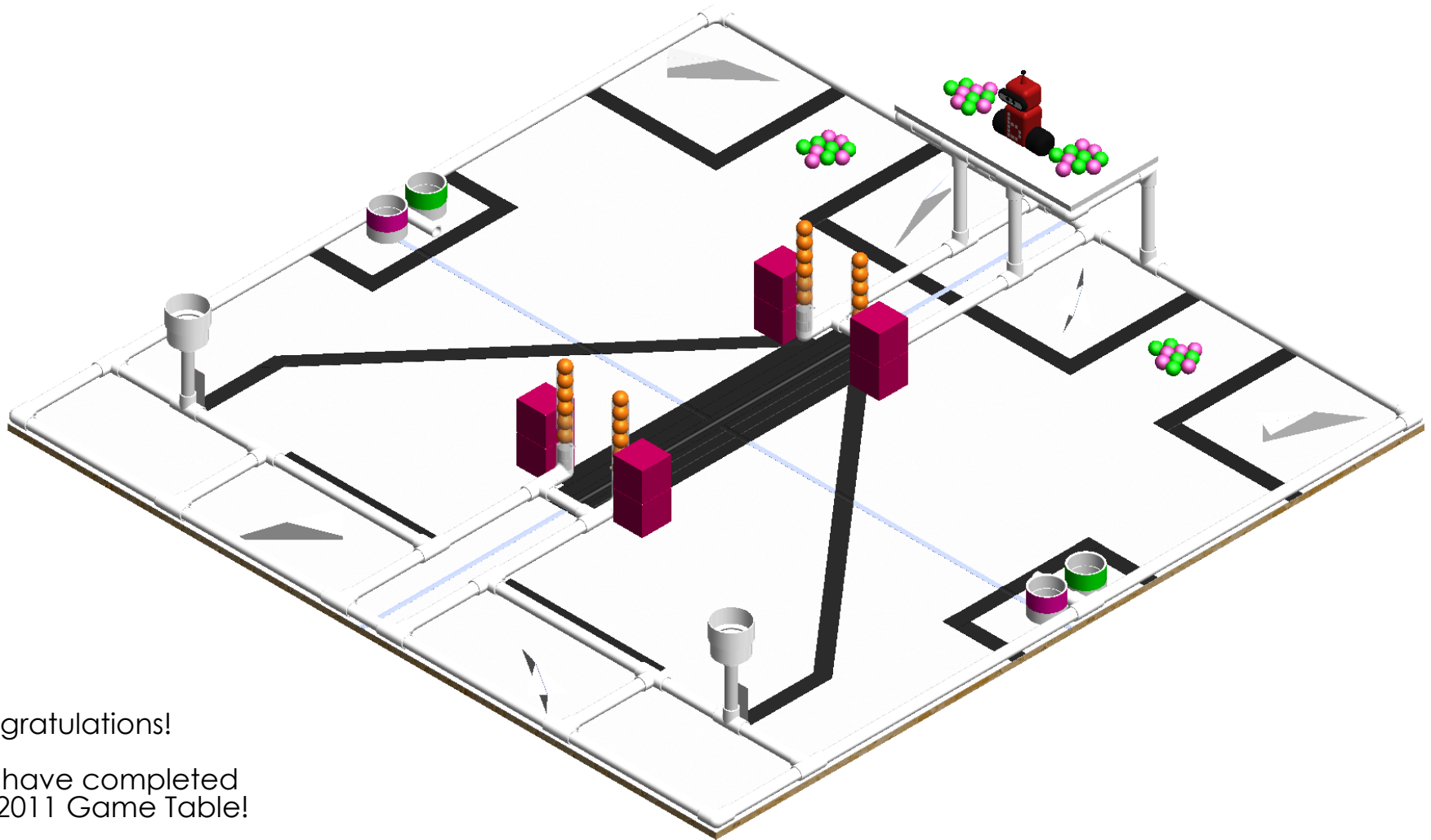

Congratulations!  
You have completed  
the 2011 Game Table!

**PROPRIETARY AND CONFIDENTIAL**  
THE INFORMATION CONTAINED IN THIS  
DRAWING IS THE SOLE PROPERTY OF  
<INSERT COMPANY NAME HERE>. ANY  
REPRODUCTION IN PART OR AS A WHOLE  
WITHOUT THE WRITTEN PERMISSION OF  
<INSERT COMPANY NAME HERE> IS  
PROHIBITED.

		UNLESS OTHERWISE SPECIFIED:		NAME	DATE	TITLE:  <b>Complete Table</b>	
		DIMENSIONS ARE IN INCHES	DRAWN				
		TOLERANCES:	CHECKED				
		FRACTIONAL ±	ENG APPR.				
		ANGULAR: MACH ± BEND ±	MFG APPR.			SIZE DWG. NO. REV	
		TWO PLACE DECIMAL ±	Q.A.				
		THREE PLACE DECIMAL ±	COMMENTS:			<b>A 2011 BB</b>	
		INTERPRET GEOMETRIC TOLERANCING PER:					
		MATERIAL				SCALE: 1:1 WEIGHT: SHEET 18 OF 18	
		FINISH					
NEXT ASSY	USED ON	APPLICATION	DO NOT SCALE DRAWING				
5	4	3	2	1			